

**BBT** SHANK A125

**BDV** SHANK B14

**HSK** SHANK C33

**ST** SHANK D8

**BIG CAPTO** SHANK E43

For N/C Lathes F6



- Compensates for synchronization errors during synchronized tapping
- Improves thread quality and tap life by reducing thrust loads caused by synchronization errors up to 90%.



**Unique new mechanism built in to compensate for synchronization errors**

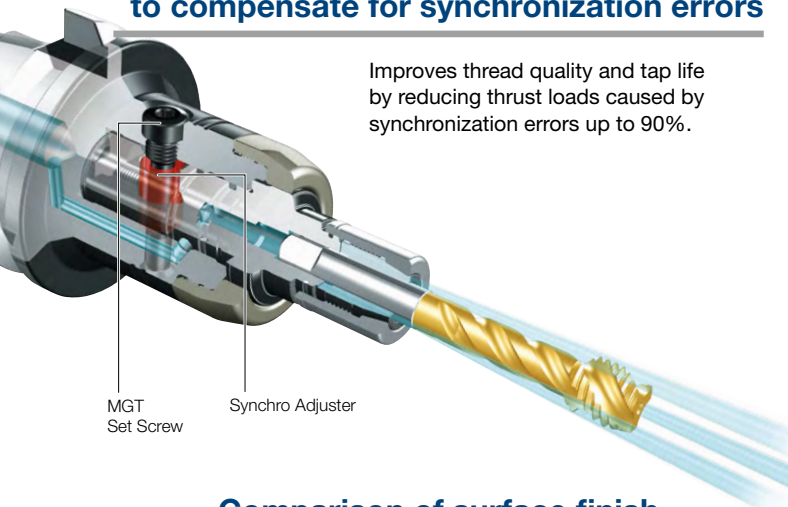

Improves thread quality and tap life by reducing thrust loads caused by synchronization errors up to 90%.

**Reduces thrust load on both the tap and workpiece.**

Due to feed misalignment occurring when the rotation is changed from forward to reverse, or tolerance to the tap pitch, 100% synchronization is hardly ever achieved. **(BIG)** MEGA SYNCHRO minimizes the thrust load to both the tap and workpiece to improve thread quality and tap life.

**Comparison of surface finish**

Tapping of difficult-to-cut materials with collet chuck tends to cause a compressed burr on the thread surface. **(BIG)** MEGA SYNCHRO compensates for synchronization errors and minimizes cutting load. Fine surface finish of threads is achieved.

**Spiral tap** M5 P0.8 Material: SNCM420

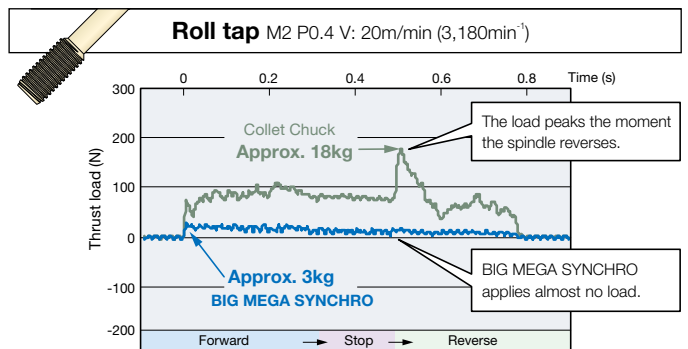
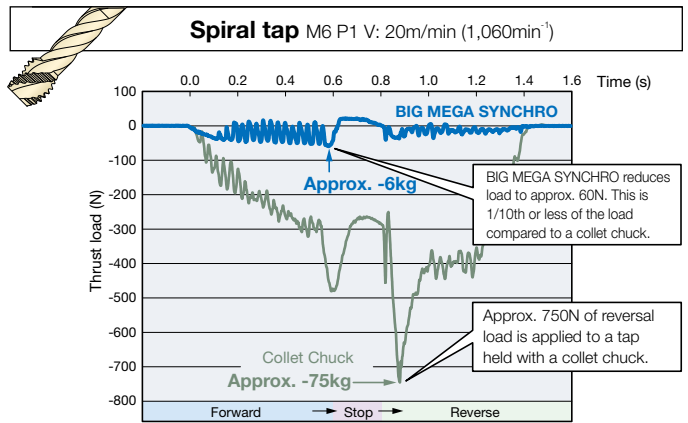
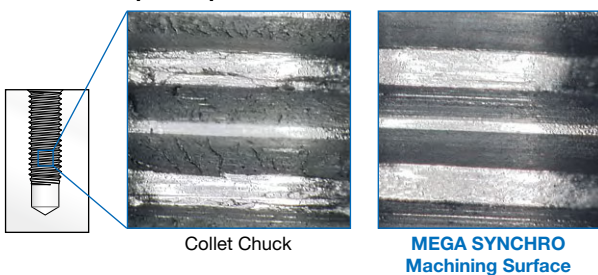

There are many cases where the tapping process comes last in parts-processing. Thus it is vital to choose the appropriate tapper for secure tapping. This applies to synchronized tappers as well. Please be careful if taps break or compressed burrs are caused frequently.

TAPPER

Improves thread quality and tap life by reducing thrust loads caused by synchronization errors up to 90%.

- Long tap holder now available as standard in addition to various tap sizes.



For tap holders **A126**.

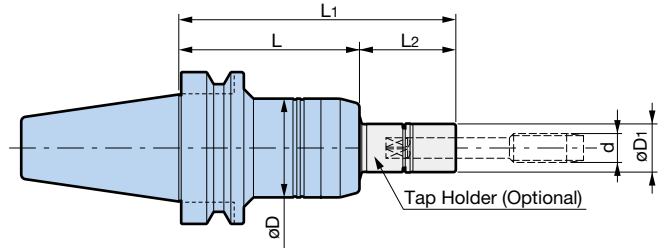
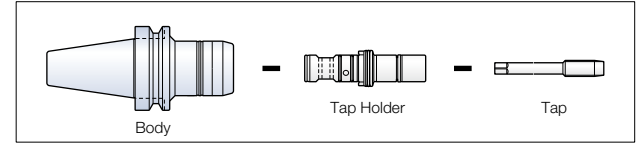

● Model Description (Body)

- BBT30** - **MGT6** - **70**
- L dimension
  - MEGA SYNCHRO No.
  - BIG-PLUS BT No.

BIG-PLUS (BBT Shank) tools can be used on both BIG-PLUS spindles and conventional **BT** spindles.

BIG-PLUS BBT SHANK Model	Tap Holder Model	Tapping range d	øD	øD <sub>1</sub>	L	L <sub>1</sub>	L <sub>2</sub>	Body weight (kg)
<b>BBT30-MGT 6- 70</b>	MGT 6-d- 30	M2 - M6 No.3 - U1/4	36	16	70	100	30	0.69
	- 70					140	70	
	-100					170	100	
<b>-MGT12- 70</b>	MGT12-d- 30	M6 - M12 U1/4 - U7/16 P1/8	41	20	70	100	30	0.74
	- 70					140	70	
	-100					170	100	
<b>-MGT20-110</b>	MGT20-d- 35	M12 - M20 U1/2 - U3/4 P1/4 - P3/8	54	30	110	145	35	1.45
	- 85					195	85	
	-115					225	115	
<b>BBT40-MGT 6- 75</b>	MGT 6-d- 30	M2 - M6 No.3 - U1/4	36	16	75	105	30	1.3
	- 70					145	70	
	-100					175	100	
<b>-MGT12- 75</b>	MGT12-d- 30	M6 - M12 U1/4 - U7/16 P1/8	41	20	75	105	30	1.4
	- 70					145	70	
	-100					175	100	
<b>-MGT20- 95</b>	MGT20-d- 35	M12 - M20 U1/2 - U3/4 P1/4 - P3/8	54	30	95	130	35	1.8
	- 85					180	85	
	-115					210	115	
<b>BBT50-MGT 6- 90</b>	MGT 6-d- 30	M2 - M6 No.3 - U1/4	36	16	90	120	30	3.9
	- 70					160	70	
	-100					190	100	
<b>-MGT12- 90</b>	MGT12-d- 30	M6 - M12 U1/4 - U7/16 P1/8	41	20	90	120	30	4.0
	- 70					160	70	
	-100					190	100	
<b>-MGT20-105</b>	MGT20-d- 35	M12 - M20 U1/2 - U3/4 P1/4 - P3/8	54	30	105	140	35	4.4
	- 85					190	85	
	-115					220	115	

- MGT Set Screw is included.
- Tap holder must be ordered separately.

Cannot be used with machining center without synchronized tapping function.

For tap holders, **A126**

$L_2 = 150, 200$  mm  
long tap holders are also available.  
For details, **A126**

# MEGA SYNCHRO TAPPING HOLDER PAT.

TAPPER

DUAL CONTACT

BBT/BT SHANK

Tap Holder PAT. (MGT6, MGT12) for JIS

- From short to long (150mm, 200mm)...

Abundant Tap Holders avoid workpiece interference flexibly.



Long type has also been standardized

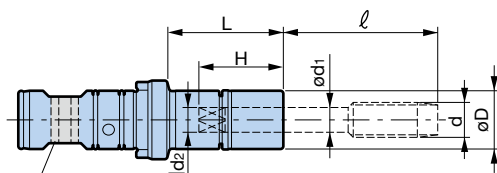

Synchro Adjuster Soft Type (Standard accessory)

- Model Description (Tap Holder)

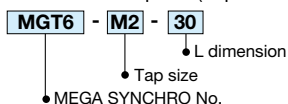

## MGT6 (Tapping range: M2 - M6)

Tap Holder Model	Tapping range d					ød <sub>1</sub>	□ d <sub>2</sub>	H	L	øD	Weight (kg)	
	Metric	ℓ	Pipe	ℓ	Unify							ℓ
MGT6-M 2 - 30	M2 - M2.6	21			No.3	21	3	2.5	19	16	30	0.12
					No.4						70	0.18
											100	0.23
											150	0.31
-M 3 - 30	M3	25			No.5	25	4	3.2	21	16	30	0.12
					No.6						70	0.18
											100	0.23
											150	0.31
-M 4 - 30	M4	27			No.8	27	5	4	25	16	30	0.12
											70	0.18
											100	0.22
											150	0.37
-M 5 - 30	M5	35			No.10	35	5.5	4.5	25	16	30	0.12
					No.12						70	0.18
											100	0.22
											150	0.3
-M6 U1/4- 30	M6	37			U1/4	37	6	4.5	25	16	30	0.12
											70	0.17
											100	0.22
											150	0.3
											200	0.37

Refer to the remarks in the table below.

## MGT12 (Tapping range: M6 - M12)

Tap Holder Model	Tapping range d					ød <sub>1</sub>	□ d <sub>2</sub>	H	L	øD	Weight (kg)	
	Metric	ℓ	Pipe	ℓ	Unify							ℓ
MGT12-M 6 U1/4- 30	M6	35			U1/4	35	6	4.5	27	20	30	0.19
											70	0.29
											100	0.36
											150	0.48
											200	0.6
-U5/16 - 30					U5/16	42	6.1	5	28	20	30	0.19
											70	0.29
											100	0.36
											150	0.48
											200	0.6
-M 8 - 30	M7, M8	42					6.2	5	28	20	30	0.19
											70	0.29
											100	0.36
											150	0.48
											200	0.6
-M10 U3/8- 30	M9, M10	47			U3/8	47	7	5.5	28	20	30	0.19
											70	0.28
											100	0.35
											150	0.47
											200	0.59
-U7/16 P1/8- 30			P1/8	26	U7/16	51	8	6	29	20	30	0.18
											70	0.28
											100	0.35
											150	0.46
											200	0.58
-M12 - 30	M12	53					8.5	6.5	29	20	30	0.18
											70	0.27
											100	0.34
											150	0.46
											200	0.58

1. Nut is included. Wrench must be ordered separately.

2. Tap projection length ℓ is a reference figure in accordance with JIS standards.

For Mega Wrench, A130

BIG A126

A  
TAPPER

**Caution**  
Refer to the precautionary notes on **A127** for tap types.

Tap Holder PAT. (MGT20) for JIS

TAPPER



Long type has also been standardized

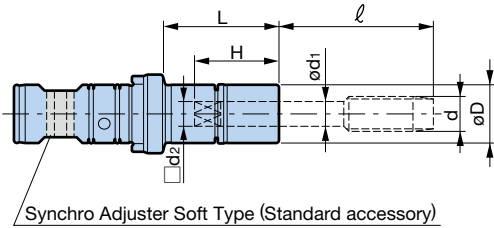

Synchro Adjuster Soft Type (Standard accessory)

● Model Description (Tap Holder)

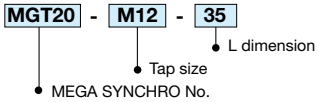

**MGT20** (Tapping range: M12 - M20)

Tap Holder Model	Tapping range d						ød <sub>1</sub>	□ d <sub>2</sub>	H	L	øD	Weight (kg)
	Metric	ℓ	Pipe	ℓ	Unify	ℓ						
<b>MGT20-M12 - 35</b>	M12	53					8.5	6.5	29	35	30	0.55
- 85										85		0.82
-115										115		0.98
-150										150		1.17
<b>-U1/2 - 35</b>					U1/2	55	9	7	30	35	30	0.55
- 85										85		0.82
-115										115		0.98
-150										150		1.17
<b>-M14 U9/16- 35</b>	M14	55			U9/16	57	10.5	8	33	35	30	0.53
- 85										85		0.79
-115										115		0.95
-150										150		1.14
<b>-P1/4 - 35</b>			P1/4	31			11	9	31	35	30	0.53
- 85										85		0.79
-115										115		0.95
-150										150		1.14
<b>-U5/8 - 35</b>					U5/8	61	12	9	34	35	30	0.52
- 85										85		0.78
-115										115		0.94
-150										150		1.13
<b>-M16 - 35</b>	M16	60					12.5	10	35	35	30	0.52
- 85										85		0.77
-115										115		0.93
-150										150		1.11
<b>-M18 U3/4- 35</b>	M18	64			U3/4	69	14	11	36	35	30	0.51
- 85										85		0.76
-115										115		0.92
-150										150		1.1
<b>-P3/8 - 35</b>			P3/8	32			14	11	33	35	30	0.51
- 85										85		0.76
-115										115		0.92
-150										150		1.1
<b>-M20 - 35</b>	M20	68					15	12	37	35	30	0.49
- 85										85		0.74
-115										115		0.89
-150										150		1.06

- Nuts are included, but wrench must be ordered separately.
- Tap projection length ℓ is a reference figure in accordance with JIS standards.

For Mega Wrench, **A130**

**⚠ Cautions: Tap Types**

Threads are more likely to expand when using a tap which has no margin on the periphery and low self-guiding properties, as with eccentric thread relief. In this case, change to the separately sold Synchro Adjuster (hard type) or use a collet chuck.

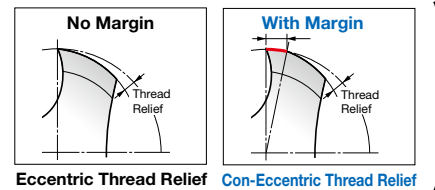

# MEGA SYNCHRO TAPPING HOLDER PAT.

TAPPER

DUAL CONTACT

BBT/BT SHANK

Tap Holder PAT. (MGT6, MGT12) for DIN / ISO

## MGT6 (Tapping range: DIN: M3 - M8 ISO: M3 - M5)



Tap Holder Model	Tapping range d (DIN)				Tapping range d (ISO)		ød <sub>1</sub>	□ d <sub>2</sub>	H	L	øD	Weight (kg)
	DIN371	DIN376	DIN353	ISO529	ISO2284							
MGT6-031025- 30										30	16	0.12
- 70										70		0.18
-100				M3		3.15	2.5	20		100		0.23
-150										150		0.31
-035027- 30										30		0.12
- 70	M3	M5				3.5	2.7	21		70		0.18
-100										100		0.23
-150										150		0.31
-040032- 30										30		0.12
- 70				M4		4.0	3.15	21		70		0.18
-100										100		0.23
-150										150		0.31
-045034- 30										30		0.12
- 70	M4	M6				4.5	3.4	21		70		0.18
-100										100		0.22
-150										150		0.30
-050040- 30										30	0.12	
- 70										70	0.18	
-100				M5		5.0	4.0	25		100	0.22	
-150										150	0.30	
-200										200	0.37	
-060049- 30										30	0.12	
- 70	M5, M6	M8				6.0	4.9	26		70	0.17	
-100										100	0.22	
-150										150	0.30	
-200										200	0.37	

1. Nuts are included, but wrench must be ordered separately.

## MGT12 (Tapping range: DIN: M5 - M12 ISO: M6 - M12)

Tap Holder Model	Tapping range d (DIN)				Tapping range d (ISO)		ød <sub>1</sub>	□ d <sub>2</sub>	H	L	øD	Weight (kg)
	DIN371	DIN376	DIN353	ISO529	ISO2284							
MGT12-060049- 30										30	20	0.19
- 70										70		0.29
-100	M5, M6	M8				6.0	4.9	28		100		0.36
-150										150		0.48
-200										200		0.60
-063050- 30										30		0.19
- 70										70		0.29
-100				M6		6.3	5.0	28		100		0.36
-150										150		0.48
-200										200		0.60
-070055- 30										30		0.19
- 70										70		0.28
-100		M10	1/8			7.0	5.5	28		100		0.35
-150										150		0.47
-200										200		0.59
-080063- 30										30		0.18
- 70										70	0.28	
-100	M8			M8	1/8	8.0	6.3	29		100	0.35	
-150										150	0.46	
-200										200	0.58	
-090071- 30										30	0.18	
- 70										70	0.27	
-100		M12		M12		9.0	7.1	30		100	0.34	
-150										150	0.46	
-200										200	0.58	
-100080- 35										35	30	0.28
- 85	M10			M10	1/4	10.0	8.0	33		85		0.49
-115										115		0.61
-150										150		0.76

1. Nuts are included, but wrench must be ordered separately.

### DIN Tap

#### DIN 371



Machine tap with reinforced shank

#### DIN 376



Machine tap with slender shank



### Caution

Refer to the precautionary notes on



**A127**

when selecting a tap.

For Mega Wrench. **A130**

**BIG** A128

A

TAPPER

Tap Holder PAT. (MGT20) for DIN / ISO

TAPPER

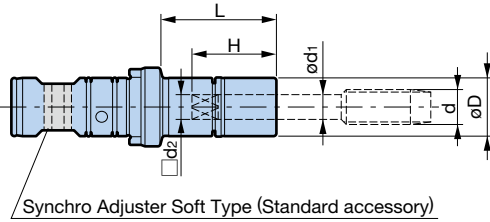

**MGT20** (Tapping range: DIN: M10 - M20 ISO: M10 - M20)

Tap Holder Model	Tapping range d (DIN)			Tapping range d (ISO)		ød <sub>1</sub>	□ d <sub>2</sub>	H	L	øD	Weight (kg)
	DIN371	DIN376	DIN353	ISO529	ISO2284						
<b>MGT20-090071- 35</b>									35	30	0.55
- 85									85		0.82
-115		M12		M12		9.0	7.1	30	115		0.98
-150									150		1.17
<b>-100080- 35</b>									35		0.54
- 85				M10	1/4	10.0	8.0	33	85		0.80
-115									115		0.96
-150									150		1.15
<b>-110090- 35</b>									35		0.53
- 85		M14	1/4			11.0	9.0	34	85		0.79
-115									115		0.95
-150									150		1.14
<b>-112090- 35</b>									35		0.53
- 85				M14		11.2	9.0	34	85		0.79
-115									115		0.95
-150									150		1.14
<b>-120090- 35</b>									35		0.52
- 85		M16	3/8			12.0	9.0	34	85		0.78
-115									115		0.94
-150									150		1.13
<b>-125100- 35</b>									35	0.52	
- 85				M16	3/8	12.5	10.0	35	85	0.77	
-115									115	0.93	
-150									150	1.11	
<b>-140110- 35</b>									35	0.51	
- 85		M18				14.0	11.0	36	85	0.76	
-115									115	0.92	
-150									150	1.10	
<b>-140112- 35</b>									35	0.51	
- 85				M18, M20		14.0	11.2	36	85	0.76	
-115									115	0.92	
-150									150	1.10	
<b>-160120- 35</b>									35	0.51	
-150		M20	1/2			16.0	12.0	37	150	1.10	

1. Nuts are included, but wrench must be ordered separately.

For Mega Wrench, **A130**

**DIN Tap**

**DIN 371**

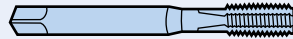

Machine tap with reinforced shank

**DIN 376**

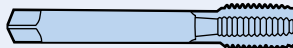

Machine tap with slender shank

**Caution**

Refer to the precautionary notes on **A127** when selecting a tap.

# MEGA SYNCHRO TAPPING HOLDER PAT.

TAPPER

DUAL CONTACT

BBT/BT SHANK

## MGT Nut PAT.

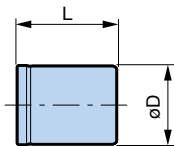

Model	øD	L	Tap Holder
<b>MGN 6T</b>	16	19	MGT 6-d- □
<b>MGN12T</b>	20	21	MGT12-d- □
<b>MGN20T</b>	30	24	MGT20-d- □

## MGT Set Screw PAT. (high-strength)

- Set screws for attaching the tap holder to the body.

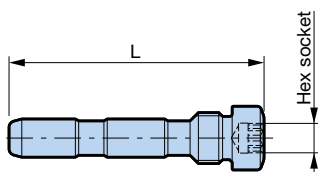

Model	Hex socket size	L	Body Model
<b>MGT 6SS</b>	4	35	MGT 6
<b>MGT12SS</b>	4	40	MGT12
<b>MGT20SS</b>	5	53	MGT20

## Synchro Adjuster

### [Soft Type]

- Special material built into the tap holder.

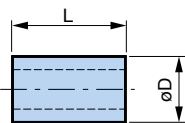

Model	øD	L	Tap Holder
<b>MGT 6SA</b>	9	11	MGT 6-d- □
<b>MGT12SA</b>	10	15	MGT12-d- □
<b>MGT20SA</b>	14	24	MGT20-d- □

- Sold as five-piece sets.
- The Synchro Adjuster soft type is provided as an accessory with the standard tap holder.

### [Hard Type]

- For use when using an eccentric thread relief tap.

Refer to A127 "Tap Types" for details.

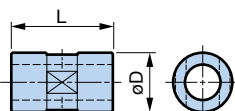

Model	øD	L	Tap Holder
<b>MGT 6SAH</b>	9	11	MGT 6-d- □
<b>MGT12SAH</b>	10	15	MGT12-d- □
<b>MGT20SAH</b>	14	24	MGT20-d- □

- Sold individually.

## O-ring Set

- Set of O-rings mounted on the tap holder.

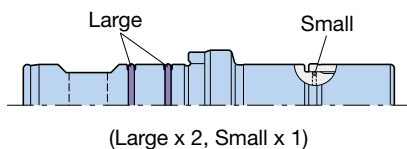

Set Model	Nut outer diameter	Tap Holder
<b>MGT 6OR</b>	ø16	MGT 6-d- □
<b>MGT12OR</b>	ø20	MGT12-d- □
<b>MGT20OR</b>	ø30	MGT20-d- □

## Mega Wrench

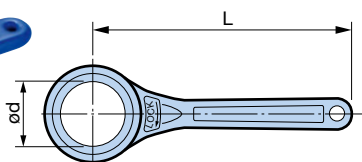

Model	ød	L	Nut Model
<b>MGR16</b>	16	90	MGN 6T
<b>MGR20L</b>	20	160	MGN12T
<b>MGR30L</b>	30	220	MGN20T

[Large Diameter Tap MGT36 PAT.]

With a structure that smoothly tracks under high cutting torque of large diameter tapping, it compensates for axial deviation due to synchronization error, greatly reducing load during tapping.



BIG-PLUS (BBT Shank) tools can be used on both BIG-PLUS spindles and conventional BT spindles.

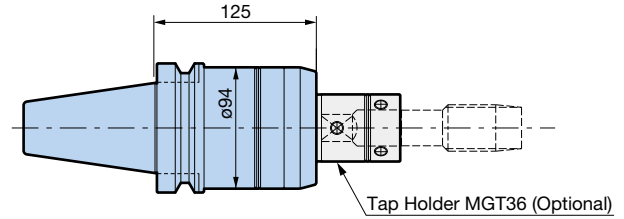
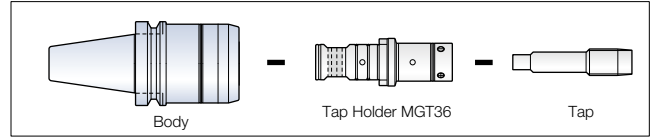

BIG-PLUS BBT SHANK Model	Body weight (kg)
<b>BBT50-MGT36-125</b>	7.2

1. MGT Set Screw is included.
2. Tap holder must be ordered separately.

Cannot be used with machining center without synchronized tapping function.

Large Diameter Tap Holder MGT36 PAT.

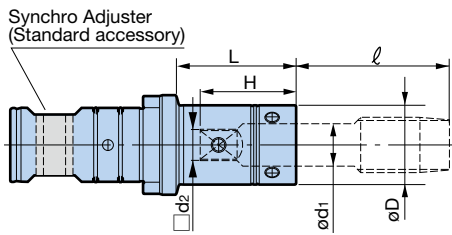

●For JIS

Tap holder model	Tap		ød <sub>1</sub>	□d <sub>2</sub>	H	øD	L	Weight (kg)
	Size	ℓ						
<b>MGT36-M20- 65</b>	M20	65 - 68	15	12	40	32	65	1.2
-150							150	1.6
<b>-M22 U7/8- 65</b>	M22,U7/8	71 - 74	17	13	44	34	65	1.3
-150							150	1.7
<b>-M24- 65</b>	M24	74 - 77	19	15	46	39	65	1.4
-150							150	2.0
<b>-M27 U1- 65</b>	M27,U1	80 - 83(M27) 75 - 78(U1)	20	15	50	40	65	1.4
-150							150	2.1
<b>-M30- 65</b>	M30	83 - 86	23	17	52	43	65	1.5
-150							150	2.3
<b>-M33- 65</b>	M33	88 - 91	25	19	57	49	65	1.6
-150							150	2.7
<b>-M36- 65</b>	M36	94 - 97	28	21	61	52	65	1.6
-150							150	2.9
<b>-P1/2- 65</b>	P1/2	38 - 41	18	14	42	35	65	1.3
-150							150	1.8
<b>-P3/4- 65</b>	P3/4	38 - 41	23	17	47	43	65	1.5
-150							150	2.3
<b>-P1 - 65</b>	P1	49 - 52	26	21	46	50	65	1.7
-150							150	2.8

1. Tap projection length ℓ is a reference figure in accordance with JIS standards.
2. Adjusting Screw is included.

●For DIN

Tap holder model	Tap size		ød <sub>1</sub>	□d <sub>2</sub>	H	øD	L	Weight (kg)
	DIN376	DIN353						
<b>MGT36-180145-65</b>	M22,24	P5/8	18	14.5	45	38	65	1.4
<b>-200160-65</b>	M27	P3/4	20	16	51	40		1.4
<b>-220180-65</b>	M30	P7/8	22	18	53	42		1.5
<b>-250200-65</b>	M33	P1	25	20	58	49		1.6
<b>-280220-65</b>	M36		28	22	62	52		1.6

1. Adjusting Screw is included.



# MEGA SYNCHRO TAPPING HOLDER PAT.

TAPPER

DUAL CONTACT

**BBT/BT**  
SHANK

## MGT Set Screw PAT. (high-strength)

- Set screws for attaching the tap holder to the body.

Model	<b>MGT36SS</b>
-------	----------------

## Synchro Adjuster (special material)

- Synchro Adjuster made of special material built into the tap holder.

Model	<b>MGT36SA</b>
-------	----------------

## Adjusting Screw

- Adjusting screw for the projection length of the tap.  
(Adjustment amount: 3mm)

Model	<b>MGT36AJ</b>
-------	----------------

## O-ring Set

- Set of O-rings mounted on the tap holder.

Model	<b>MGT36OR</b>
-------	----------------

## Side Lock Bolt Set

Set Model	Tap Holder Model	Bolt size
<b>MGT36SL 6</b>	MGT36-M20-□	M6x 8L (4 pcs)
	-M22 U7/8-□	+
	-P1/2-□	M6x10L (2 pcs)
<b>MGT36SL 8</b>	-M24-□	M8x10L (4 pcs)
	-M27 U1-□	+
	-M30-□	M8x12L (2 pcs)
	-P3/4-□	
<b>MGT36SL10</b>	-M33-□	M10x12L (4 pcs)
	-M36-□	+
	-P1 -□	M10x14L (2 pcs)

[Small Diameter Tap MGT3 PAT.]

Stable small diameter tapping is achieved by the synchronization error compensation mechanism and minimized dynamic runout.



BIG-PLUS (BBT Shank) tools can be used on both BIG-PLUS spindles and conventional **BT** spindles.

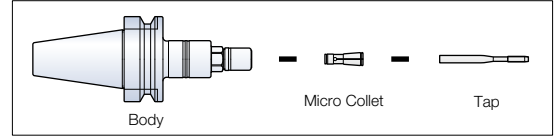

BIG-PLUS BBT SHANK Model	Tapping range d	øD	L	L <sub>1</sub>	L <sub>2</sub>	Weight (kg)
<b>BBT30-MGT3-70</b>	M1 - M3	20	70	46	22	0.49
<b>BBT40-MGT3-90</b>			90	61		

- Nut is included. Wrench and collet must be ordered separately.
  - When attaching or detaching the tap, a commercially available flat wrench (12mm width) is also required. Prepare this on your own.
- Cannot be used with machining center without synchronized tapping function.
  - Cannot be used with center through.

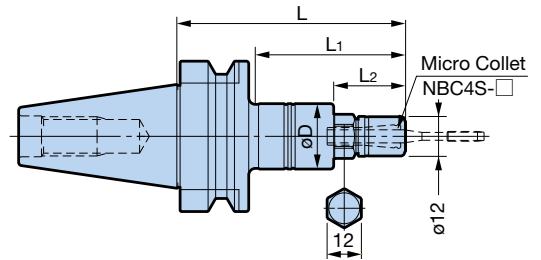

## Mega Wrench



Model	<b>MGR12</b>
-------	--------------

- When attaching or detaching the tap, a commercially available flat wrench (12mm width) is also required. Prepare this on your own.

## Micro Collet

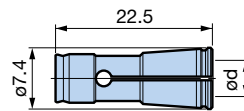

Model	Tapping range		Tap shank diameter ød
	Metric	Unify	
<b>NBC4S - 3.0AA</b>	M1 - M2.6	No.0 - 4	3
<b>NBC4S - 4.0AA</b>	M3	No.5, 6	4

### ● Collet accuracy

Collet class	Runout accuracy	
	Nose	4D
AA	Within 1 μm	Within 3 μm

# MEGA SYNCHRO TAPPING HOLDER PAT.

Improves thread quality and tap life by reducing thrust loads caused by synchronization errors up to 90%.

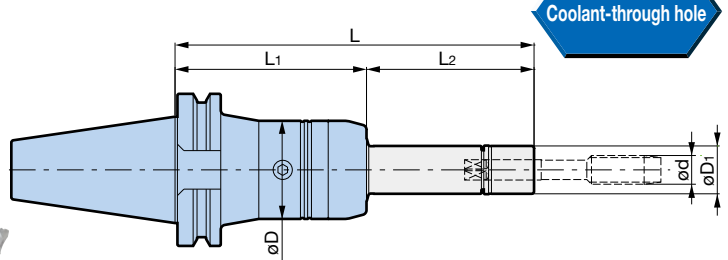
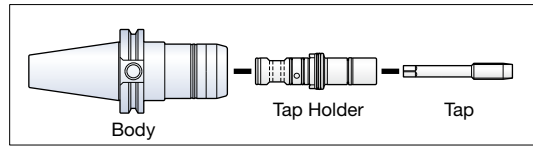

B  
TAPPER

BIG-PLUS BDV SHANK Model	Tap Holder Model	Tapping range d	øD	øD <sub>1</sub>	L	L <sub>1</sub>	L <sub>2</sub>	Weight (kg)
BDV40-MGT 6- 80	MGT 6-d- 30	M2 - M6 No.3 - U1/4	36	16	110	80	30	1.3
	- 70				150		70	
	-100				180		100	
-MGT12- 80	MGT12-d- 30	M6 - M12 U1/4 - U7/16 P1/8	41	20	110	80	30	1.3
	- 70				150		70	
	-100				180		100	
-MGT20-105	MGT20-d- 35	M12 - M20 U1/2 - U3/4 P1/4 - P3/8	54	30	140	105	35	1.9
	- 85				190		85	
	-115				220		115	
BDV50-MGT 6- 85	MGT 6-d- 30	M2 - M6 No.3 - U1/4	36	16	115	85	30	3.2
	- 70				155		70	
	-100				185		100	
-MGT12- 85	MGT12-d- 30	M6 - M12 U1/4 - U7/16 P1/8	41	20	115	85	30	3.2
	- 70				155		70	
	-100				185		100	
-MGT20-105	MGT20-d- 35	M12 - M20 U1/2 - U3/4 P1/4 - P3/8	54	30	140	105	35	3.8
	- 85				190		85	
	-115				220		115	

- MGT Set Screw is included.
- Tap holder and wrench are not included. Please order separately.  
Cannot be used with machining center without synchronized tapping function.

**Caution**

Tap with eccentric thread relief, having no margin on tap periphery, may cause oversize threads. In such case, tap with con-eccentric thread relief is recommended. **A127**

For tap holders, **A128**

## ● Tapping range (DIN/ISO)

Tap Holder Size	DIN Standard			ISO Standard	
	DIN371	DIN376	DIN353	ISO529	ISO2284
<b>MGT 6</b>	M3 - M6	M 5 - M 8		M 3 - M5	
<b>MGT12</b>	M5 - M8	M 8 - M12	1/8	M6, M8, M12	1/8
<b>MGT20</b>	M10	M12 - M20	1/4 - 1/2	M10 - M20	1/4 - 3/8

For tap holders, **A128**

## [Large Diameter Tap MGT36]

M22 - M36

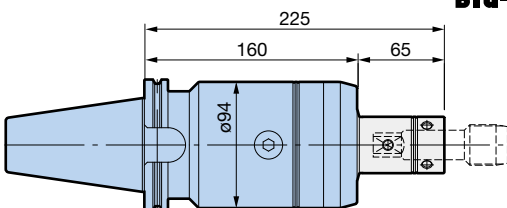

BIG-PLUS BDV SHANK Model	Weight (kg)
<b>BDV50-MGT36-160</b>	8.7

- MGT Set Screw is included.
- Tap holder must be ordered separately.  
Cannot be used with machining center without synchronized tapping function.

## ■ Tap Holder MGT36 DIN standard

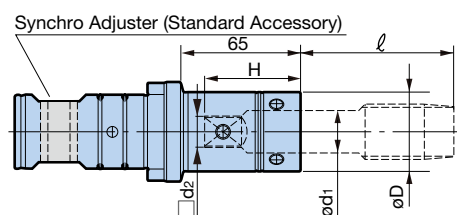

Tap Holder Model	Tap size		ød <sub>1</sub>	□ d <sub>2</sub>	H	øD	Weight (kg)
	DIN376	DIN353					
<b>MGT36-180145-65</b>	M22, 24	P5/8	18	14.5	45	38	1.4
<b>-200160-65</b>	M27	P3/4	20	16	51	40	1.4
<b>-220180-65</b>	M30	P7/8	22	18	53	42	1.5
<b>-250200-65</b>	M33	P1	25	20	58	49	1.6
<b>-280220-65</b>	M36		28	22	62	52	1.6

For JIS Tap Holders, **A131**



Improves thread quality and tap life by reducing thrust loads caused by synchronization errors up to 90%.

● Long tap holder now available as standard in addition to various tap sizes.



For tap holders **A126**

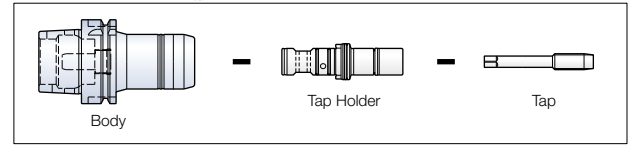

● Model Description (Body)

**HSK-A40** - **MGT6** - **80**

- L dimension
- MEGA SYNCHRO No.
- HSK Shank Type

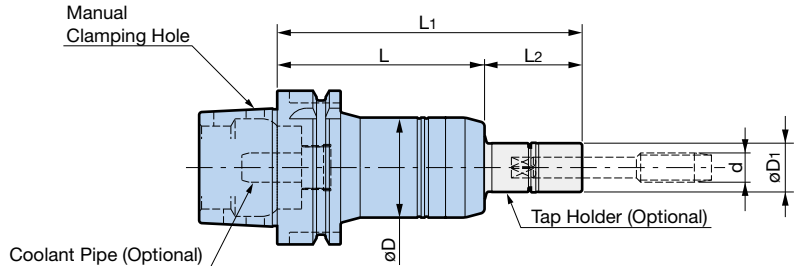

## A Type (DIN 69893-1) (ISO 12164)

Model	Tap Holder Model	Tapping range d	øD	øD <sub>1</sub>	L	L <sub>1</sub>	L <sub>2</sub>	Body weight (kg)
<b>HSK-A 40-MGT 6- 80</b>	MGT 6-d- 30	M2 - M6 No.3 - U1/4	36	16	80	110	30	0.6
	- 70					150	70	
	-100					180	100	
<b>-MGT12- 85</b>	MGT12-d- 30	M6 - M12 U1/4 - U7/16 P1/8	41	20	85	115	30	0.7
	- 70					155	70	
	-100					185	100	
<b>HSK-A 50-MGT 6- 85</b>	MGT 6-d- 30	M2 - M6 No.3 - U1/4	36	16	85	115	30	0.8
	- 70					155	70	
	-100					185	100	
<b>-MGT12- 85</b>	MGT12-d- 30	M6 - M12 U1/4 - U7/16 P1/8	41	20	85	115	30	0.9
	- 70					155	70	
	-100					185	100	
<b>-MGT20-125</b>	MGT20-d- 35	M12 - M20 U1/2 - U3/4 P1/4 - P3/8	54	30	125	160	35	1.6
	- 85					210	85	
	-115					240	115	
<b>HSK-A 63-MGT 6- 85</b>	MGT 6-d- 30	M2 - M6 No.3 - U1/4	36	16	85	115	30	1.1
	- 70					155	70	
	-100					185	100	
<b>-MGT12- 85</b>	MGT12-d- 30	M6 - M12 U1/4 - U7/16 P1/8	41	20	85	115	30	1.2
	- 70					155	70	
	-100					185	100	
<b>-MGT20-110</b>	MGT20-d- 35	M12 - M20 U1/2 - U3/4 P1/4 - P3/8	54	30	110	145	35	1.8
	- 85					195	85	
	-115					225	115	
<b>HSK-A100-MGT 6- 95</b>	MGT 6-d- 30	M2 - M6 No.3 - U1/4	36	16	95	125	30	2.6
	- 70					165	70	
	-100					195	100	
<b>-MGT12- 95</b>	MGT12-d- 30	M6 - M12 U1/4 - U7/16 P1/8	41	20	95	125	30	2.7
	- 70					165	70	
	-100					195	100	
<b>-MGT20-115</b>	MGT20-d- 35	M12 - M20 U1/2 - U3/4 P1/4 - P3/8	54	30	115	150	35	3.3
	- 85					200	85	
	-115					230	115	
<b>HSK-A125-MGT12-105</b>	MGT12-d- 30	M6 - M12 U1/4 - U7/16 P1/8	41	20	105	135	30	4.1
	- 70					175	70	
	-100					205	100	
<b>-MGT20-120</b>	MGT20-d- 35	M12 - M20 U1/2 - U3/4 P1/4 - P3/8	54	30	120	155	35	4.7
	- 85					205	85	
	-115					235	115	

1. MGT Set Screw is included.
  2. Tap holder is not included. Please order separately.
  3. Coolant pipe is not included. **C65**
- Cannot be used with machining center without synchronized tapping function.

For tap holders, **A126**

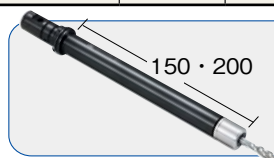

**L<sub>2</sub> = 150, 200mm**  
long tap holders are also available.  
For details, **A126**

## [Small Diameter Tap MGT3 PAT.] M1 - M3

Stable small diameter tapping is achieved by the synchronization error compensation mechanism and minimized dynamic runout.

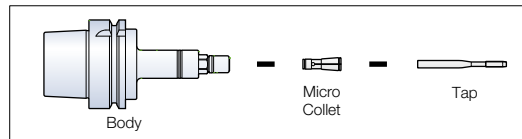

### A Type (DIN 69893-1) (ISO 12164)

Model	Body weight (kg)
<b>HSK-A63-MGT3-100</b>	1.0

- Nut is included, but wrench and collet are not. Please order separately.
  - When attaching or detaching the tap, a commercially available flat wrench (12mm width) is also required. Prepare this on your own.
- Cannot be used with machining center without synchronized tapping function.
  - Cannot be used with center through.

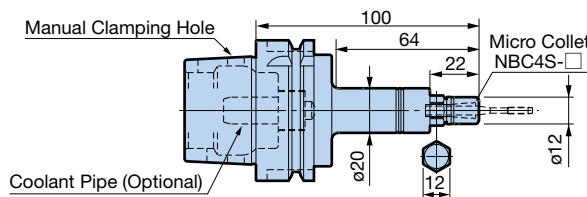

For Mega Wrench and Collets, **A133**

## [Large Diameter Tap MGT36 PAT.] M20 - M36

With a structure that smoothly tracks under high cutting torque of large diameter tapping, it compensates for axial deviation due to synchronization error, greatly reducing load during tapping.



For tap holders **A131**

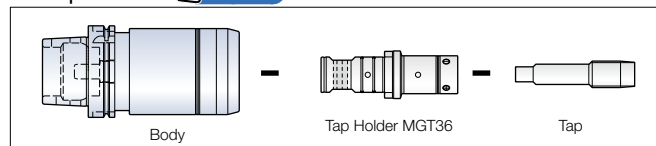

### A Type (DIN 69893-1) (ISO 12164)

Model	øD	L	Body weight (kg)
<b>HSK-A100-MGT36-165</b>	94	165	8.2
<b>HSK-A125-MGT36-170</b>	94	170	10.1

- MGT Set Screw is included.
  - Tap holder is not included. Please order separately.
  - Coolant pipe is not included. **C65**
- Cannot be used with machining center without synchronized tapping function.

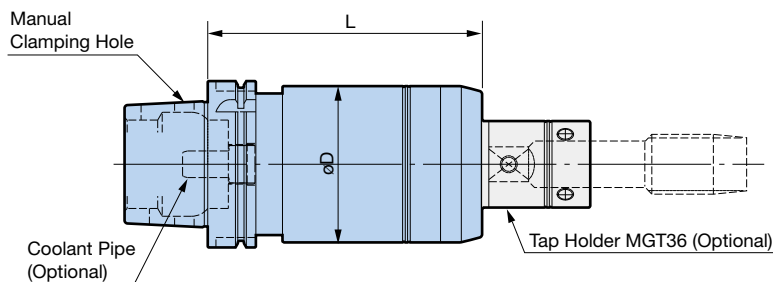

For MGT36 accessories, **A132**

# MEGA SYNCHRO TAPPING HOLDER PAT.

Improves thread quality and tap life by reducing thrust loads caused by synchronization errors up to 90%.

Center through

- Long tap holder now available as standard in addition to various tap sizes.



● Model Description (Body)

**ST20** - **MGT6** - **65**

● L dimension  
● MEGA SYNCHRO No.  
● Cylindrical shank No.

For tap holders **A126**.

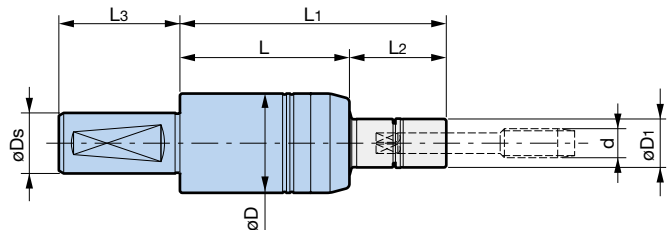
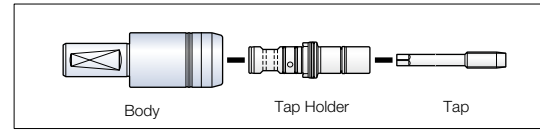

※ Use the **BIG** Side Lock Holder (TSL). **A121**

Model	Tap Holder Model	Tapping range d	øD	øD1	øDs	L	L1	L2	L3	Weight (kg)
<b>ST20-MGT 6-65</b>	MGT 6-d- 30	M2 - M6 No.3 - U1/4	36	16	20	65	95	30	40	0.5
	- 70						135	70		
	-100						165	100		
<b>ST25-MGT12-70</b>	MGT12-d- 30	M6 - M12 U1/4 - U7/16 P1/8	41	20	25	70	100	30	50	0.8
	- 70						140	70		
	-100						170	100		
<b>ST32-MGT20-90</b>	MGT20-d- 35	M12 - M20 U1/2 - U3/4 P1/4 - P3/8	54	30	32	90	125	35	55	1.5
	- 85						175	85		
	-115						205	115		

- MGT Set Screw is included.
  - Tap holder is not included. Please order separately. **A126**
- Cannot be used with machining center without synchronized tapping function.

**SYNCHRONIZED TAP HOLDER STD52 M39 - M52**

**L2=150, 200mm** tap holders are also available. For details, see **A126 - A129**

[Small Diameter Tap MGT3 PAT.] M1 - M3



Model **ST20-MGT3-90**

- Nut is included. Wrench and collet must be ordered separately.
  - When attaching or detaching the tap, a commercially available flat wrench (12mm width) is also required. Prepare this on your own.
- Cannot be used with machining center without synchronized tapping function.
  - Cannot be used with center through.

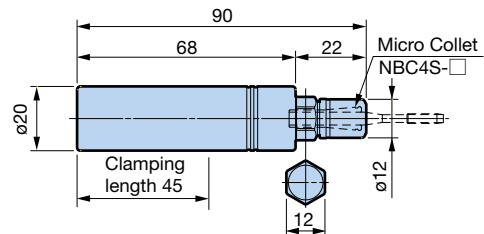
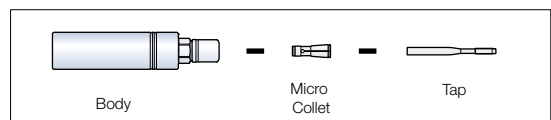

● Mega Wrench

● Micro Collet



Model **MGR12**

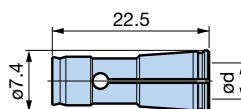

Model	Tapping range		Tap shank diameter ød
	Metric	Unify	
<b>NBC4S - 3.0AA</b>	M1 - M2.6	No.0 - 4	3
<b>NBC4S - 4.0AA</b>	M3	No.5, 6	4

- When attaching or detaching the tap, a commercially available flat wrench (12mm width) is also required. Prepare this on your own.

Center through

Absorbs and corrects machine synchronization errors for improved tap life.

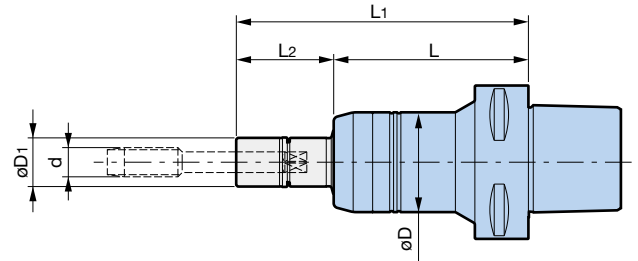
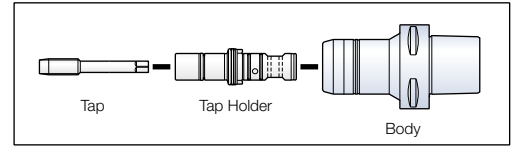

- Model Description (Body)
- C5** - **MGT6** - **75**
- L dimension
- MEGA SYNCHRO No.
- Shank No.

**C5/C6/C8**

Model	Tap Holder Model	Tapping range $d$	$\phi D$	$\phi D_1$	L	$L_1$	$L_2$	Weight (kg)
<b>C5-MGT 6- 75</b>	MGT 6-d- 30	M2 - M6 No.3 - U1/4	36	16	75	105	30	0.8
	- 70					145	70	
	-100					175	100	
<b>-MGT12- 75</b>	MGT12-d- 30	M6 - M12 U1/4 - U7/16 P1/8	41	20	75	105	30	0.9
	- 70					145	70	
	-100					175	100	
<b>-MGT20-100</b>	MGT20-d- 35	M12 - M20 U1/2 - U3/4 P1/4 - P3/8	54	30	100	135	35	1.4
	- 85					185	85	
	-115					215	115	
<b>C6-MGT 6- 80</b>	MGT 6-d- 30	M2 - M6 No.3 - U1/4	36	16	80	110	30	1.1
	- 70					150	70	
	-100					180	100	
<b>-MGT12- 80</b>	MGT12-d- 30	M6 - M12 U1/4 - U7/16 P1/8	41	20	80	110	30	1.2
	- 70					150	70	
	-100					180	100	
<b>-MGT20-100</b>	MGT20-d- 35	M12 - M20 U1/2 - U3/4 P1/4 - P3/8	54	30	100	135	35	1.8
	- 85					185	85	
	-115					215	115	
<b>C8-MGT 6- 80</b>	MGT 6-d- 30	M2 - M6 No.3 - U1/4	36	16	80	110	30	2.1
	- 70					150	70	
	-100					180	100	
<b>-MGT12- 80</b>	MGT12-d- 30	M6 - M12 U1/4 - U7/16 P1/8	41	20	80	110	30	2.2
	- 70					150	70	
	-100					180	100	
<b>-MGT20- 95</b>	MGT20-d- 35	M12 - M20 U1/2 - U3/4 P1/4 - P3/8	54	30	95	130	35	2.6
	- 85					180	85	
	-115					210	115	

1. MGT Set Screw is included.
2. Tap holder is not included. Please order separately.

Cannot be used with machining center without synchronized tapping function.

$L_2=150, 200$ mm tap holders are also available. For details, see **A126 - A129**

For tap holders, **A126**

BIG CAPTO SHANK

Improves thread quality and tap life by reducing thrust loads caused by synchronization errors up to 90%.



[Small Diameter Tap MGT3 PAT.]

· Cannot be used with machining center without synchronized tapping function.

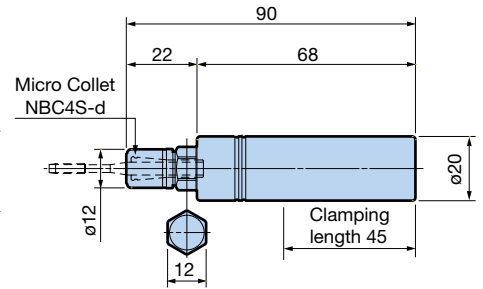
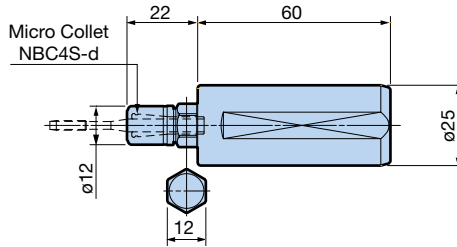

● Model Description

**SLS25** - **MGT3** - **22**

- Side lock shank diameter
- MEGA SYNCHRO TAPPING HOLDER
- Tip length

Model	<b>SLS25-MGT3-22</b>
-------	----------------------

1. Nut is included. (MGN4S)  
Collet and wrench must be ordered separately.
2. When attaching or detaching the tap, use the Mega Wrench and a commercially available flat wrench (12mm).

Model	<b>ST20-MGT3-90</b>
-------	---------------------

1. Nut is included. (MGN4S)  
Collet and wrench must be ordered separately.
2. There is no flat on the shank part.
3. When attaching or detaching the tap, use the Mega Wrench and a commercially available flat wrench (12mm).

## Mega Wrench



Model	<b>MGR12</b>
-------	--------------

1. When attaching or detaching the tap, a commercially available flat wrench (12mm width) is also required.  
Prepare this on your own.

## Micro Collet

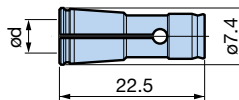

Model	Tapping range		Tap shank diameter ød
	Metric	Unify	
<b>NBC4S - 3.0AA</b>	M1 - M2.6	No.0 - 4	3
<b>NBC4S - 4.0AA</b>	M3	No.5, 6	4

● Collet accuracy

Collet class	Runout accuracy	
	Nose	4D
AA	Within 1 μm	Within 3 μm

- Built-in radial float mechanism absorbs misalignment with the spindle center. Excellent for rigid tapping with NC Lathes.
- Small axial float absorbs synchronization errors occurring when changing over the rotation from forward to reverse, reducing loads to the tap.

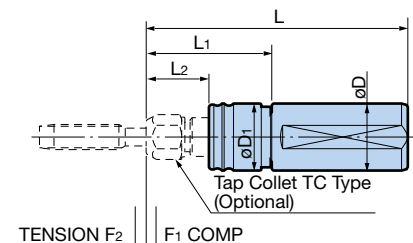

Radial float = ±0.5mm/ø

● Model Description

**SLS32** - **ATS** **12** **R** - **60**

- Side lock shank diameter
- SYNCHRONIZED TAP HOLDER R
- Tapping range
- Radial float mechanism
- L1 dimension

Model	Tapping range	øD	øD <sub>1</sub>	L	L <sub>1</sub>	L <sub>2</sub>	F <sub>1</sub>	F <sub>2</sub>	Compatible Tap Collet
<b>SLS32-ATS12R- 60</b>	M3 - M12	32	32	125	60	30	0.5	0.5	TC12-d
<b>SLS40-ATS12R- 60</b>		40	32	125	60	25	0.5	0.5	
<b>-ATS20R- 70</b>	M8 - M20	40	44	145	70	25	0.5	0.5	TC20-d

1. Tap Collet is not included.  
TC Tap Collet must be ordered separately.

F<sub>1</sub>: Compression amount  
F<sub>2</sub>: Tension amount

· Cannot be used with machining center without synchronized tapping function.

