



An inspection certificate is supplied as standard. Refer to page U-11 for details.

Technical Data

Flatness: 0.6 μm /0.00024 in
 Parallelism: 2 μm /0.0008 in
 Measuring force: 5-10 N
 Standard accessories: Reference bar, 1 pc.
 (except for measuring range 0-25 mm (0-1 in) models)
 Spanner (301336), 1 pc.

Internal Structure

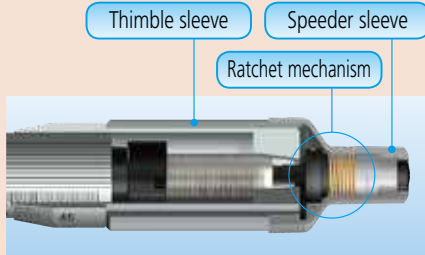

Greatly Improved Accuracy and Repeatability

Measurement results of one-handed operation

A beginner performed a test by measuring a workpiece 20 times using a conventional micrometer and a Ratchet Thimble Micrometer.

Table showing results of test

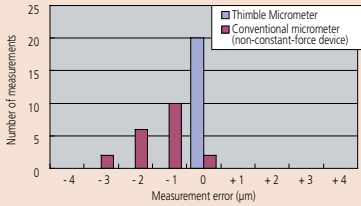

Ratchet Thimble Micrometer SERIES 102 — Outside Micrometers

- More accurate in one-handed operation: inexperienced operators measure significantly more accurately with the new micrometer.
- Ratchet function works both from the thimble and the speeder.

- Rotating the thimble/speeder when the workpiece is between the anvil and spindle causes the ratchet mechanism to operate and apply a constant measuring force to the workpiece.
- Clearly audible ratchet operation for reassurance that measurement is being performed at constant, preset force.
- The speeder is always available for quick rotation of spindle.
- A simple mechanism, which requires neither parts maintenance nor special technique, is employed in the constant-force device.
- Heat-insulated frame.
- Measuring faces: Carbide.

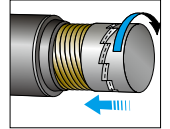

SPECIFICATIONS

Metric				
Order No.	Range (mm)	Graduation (mm)	Accuracy (μm)	Mass (g)
102-701	0 - 25	0.01	± 2	180
102-707		0.001		
102-702	25 - 50	0.01		
102-708		0.001		

Inch				
Order No.	Range (in)	Graduation (in)	Accuracy (in)	Mass (g)
102-717	0 - 1	0.0001	± 0.0001	180
102-718	1 - 2			270

DIMENSIONS

