

Technical Data

- Accuracy: $\pm(2 + R/75) \mu\text{m}$, R = max. range (mm) fraction rounded up



Standard Accessories

Spanner (301336), 1 pc.

Screw Thread Micrometers SERIES 125

- Fixed anvil type to suit 60° threads.
- Directly indicates screw pitch diameter (no need for calculation).
- Equipped with Ratchet Stop for constant measuring force.

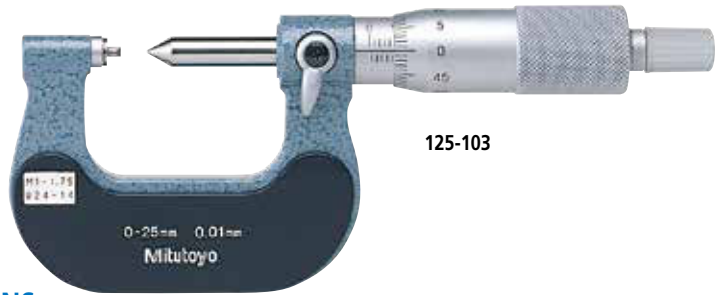

125-103

SPECIFICATIONS

Metric			
Order No.	Thread to be measured (Metric/Unified)	Range (mm)	Graduation (mm)
125-101	0.4 - 0.5 mm/64 - 48TPI	0 - 25	0.01
125-102	0.6 - 0.9 mm/44 - 28TPI		
125-103	1 - 1.75 mm/24 - 14TPI		
125-104	2 - 3 mm/13 - 9TPI		
125-105	3.5 - 5 mm/8 - 5TPI		
125-106	0.4 - 0.5 mm/64 - 48TPI	25 - 50	
125-107	0.6 - 0.9 mm/44 - 28TPI		
125-108	1 - 1.75 mm/24 - 14TPI		
125-109	2 - 3 mm/13 - 9TPI		
125-110	3.5 - 5 mm/8 - 5TPI		

Metric			
Order No.	Thread to be measured (Metric/Unified)	Range (mm)	Graduation (mm)
125-111	0.6 - 0.9 mm/44 - 28TPI	50 - 75	0.01
125-112	1 - 1.75 mm/24 - 14TPI		
125-113	2 - 3 mm/13 - 9TPI		
125-114	3.5 - 5 mm/8 - 5TPI		
125-115	5.5 - 7 mm/4.5 - 3.5TPI		
125-116	0.6 - 0.9 mm/44 - 28TPI	75 - 100	
125-117	1 - 1.75 mm/24 - 14TPI		
125-118	2 - 3 mm/13 - 9TPI		
125-119	3.5 - 5 mm/8 - 5TPI		
125-120	5.5 - 7 mm/4.5 - 3.5TPI		

Note: A matching setting standard is supplied with each model (except for 0-25 mm measuring range). (Refer to page B-63 for details.)
The setting standard is for metric threads (unified) 60°.

DIMENSIONS

125-101, 125-106

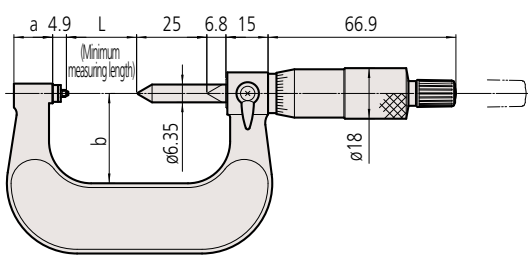

Range (mm)	L	a	b
0 - 25	0	13.8	25
25 - 50	25		32

125-111, 125-116

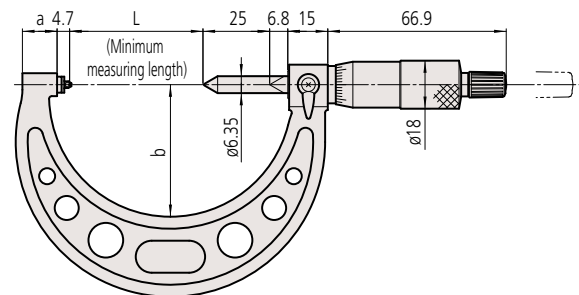

Range (mm)	L	a	b
50 - 75	50	12	49
75 - 100	75	14	63

Unit: mm