

Calipers

An industry standard measuring tool

ABSOLUTE Digimatic Caliper 551 Series - with Nib Style and Standard Jaws

MeasurLink[®] ENABLED
Data Management Software by Mitutoyo

- Offers a resolution of 0.01 mm with corresponding accuracy.
- Incorporates an Absolute measurement system. No need to reset the origin after switching on. (Refer to page D-8 for a description of Absolute measurement.)
- Allows integration into statistical process control and measurement systems for models with measurement data output connector. Refer to page A-3.
- ID measurement value: displayed value + (a compensation value displayed on the main unit). OFFSET switch allows to input a compensation value so that the measurement value can be read directly (**Order No. 551-301-20, 551-331-10, 551-311-20 and 551-341-10**). Preset function allows to set a desired starting point (**Order No. 551-331-10 and 551-341-10**).
- Tips of the outside measurement jaw are relieved for easy measurement of thin parts.



551-301-20

Compensation value

SPECIFICATIONS

Metric

Order No.	Range (mm)*	Accuracy (mm)	Remarks
551-301-20	0 - 200 (10.1 - 210)	±0.03	IP67
551-331-10	0 - 300 (10.1 - 310)	±0.04	IP67, with offset/preset function for easy inside measurement
551-204-10	0 - 500 (20.1 - 520)	±0.06	—
551-206-10	0 - 750 (20.1 - 770)	±0.06	
551-207-10	0 - 1000 (20.1 - 1020)	±0.07	

* () : inside measurement

Note: Series 551 is not equipped with a depth bar.

Inch/Metric

Order No.	Range (in)*	Accuracy (in)	Remarks
551-311-20	0 - 8 (0.404 - 8.4)	±0.0015	IP67
551-341-10	0 - 12 (0.404 - 12.4)	±0.002	IP67, with offset/preset function for easy inside measurement
551-224-10	0 - 20 (0.504 - 20.5)	±0.0025	—
551-226-10	0 - 30 (0.504 - 30.5)	±0.0025	
551-227-10	0 - 40 (1.004 - 41)	±0.003	

* () : inside measurement

Note: Series 551 is not equipped with a depth bar.

DIMENSIONS

Range (mm)	B	C	D	G	S	H	t	R
0 - 200	30	23.6	60	5	8	16	3	5
0 - 300	40.1	32.4	90		10	20	3.8	
0 - 500	56	44.9	150	10	15	25	6	10
0 - 750	56				20	32	8	
0 - 1000	56	43.8						

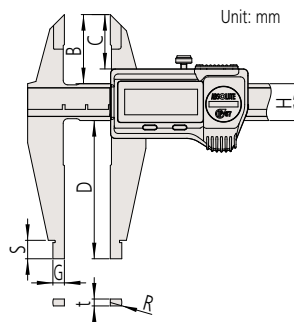

MeasurLink[®] ENABLED
Data Management Software by Mitutoyo

Products equipped with the measurement data output function can be connected to the measurement data network system MeasurLink (refer to page A-5 for details).

ABSOLUTE[™]

IP67



www.tuv.com
ID 000045042

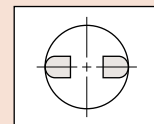
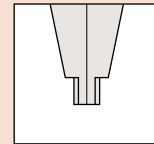

Radiused jaws for accurate ID measurement

Technical Data

- Accuracy: Refer to the list of specifications. (excluding quantizing error for Digimatic models)
 - Resolution: 0.01 mm or 0.0005 inch/0.01 mm
 - Display: LCD
 - Scale type: ABSOLUTE electromagnetic induction linear encoder
 - Max. response speed: Unlimited
 - Battery: SR44 (1 pc), **938882**, for initial operational checks (standard accessory)
 - Battery life: Approx. 5 years under normal use (1 year: 300 mm models) (3.5 years: over 300 mm models)
 - Dust/Water protection level: IP67* (models up to 300 mm)
- * Rustproofing shall be applied after use if caliper was in contact with coolant.

Optional Accessories

For details, refer to page D-38.

- **959143**: Data hold unit
- Connecting cables for **IT/DP/MUX**
 - **05CZA624**: SPC cable with data button (1 m)*
 - **05CZA625**: SPC cable with data button (2 m)*
 - **959149**: SPC cable with data button (1 m)
 - **959150**: SPC cable with data button (2 m)
- USB Input Tool Direct
 - **06AFM380A**: SPC cable for **USB-ITN-A** (2 m)*
 - **06AFM380C**: SPC cable for **USB-ITN-C** (2 m)
- Connecting cables for **U-WAVE-T**
 - **02AZD790A**: SPC cable with data button (160 mm)
 - **02AZE140A**: SPC cable for foot switch

Wireless Data Output **U-WAVE^{fit}**

- **U-WAVE-TC: 264-620** (IP67 type)
264-621 (Buzzer type)
 - Connecting unit for **U-WAVE-TC: 02AZF310** (IP67 type)
- Note: IP67 model is water/dust-proofed suitable for the factory floor.
Buzzer type is not water/dust-proofed.
Refer to page A-15 for details.
* For IP67 models (up to 300 mm)