

Depth Gage

A standard measuring tool of industry

Dial Depth Gage SERIES 7

- Optimal for hole, narrow groove and step measurement.

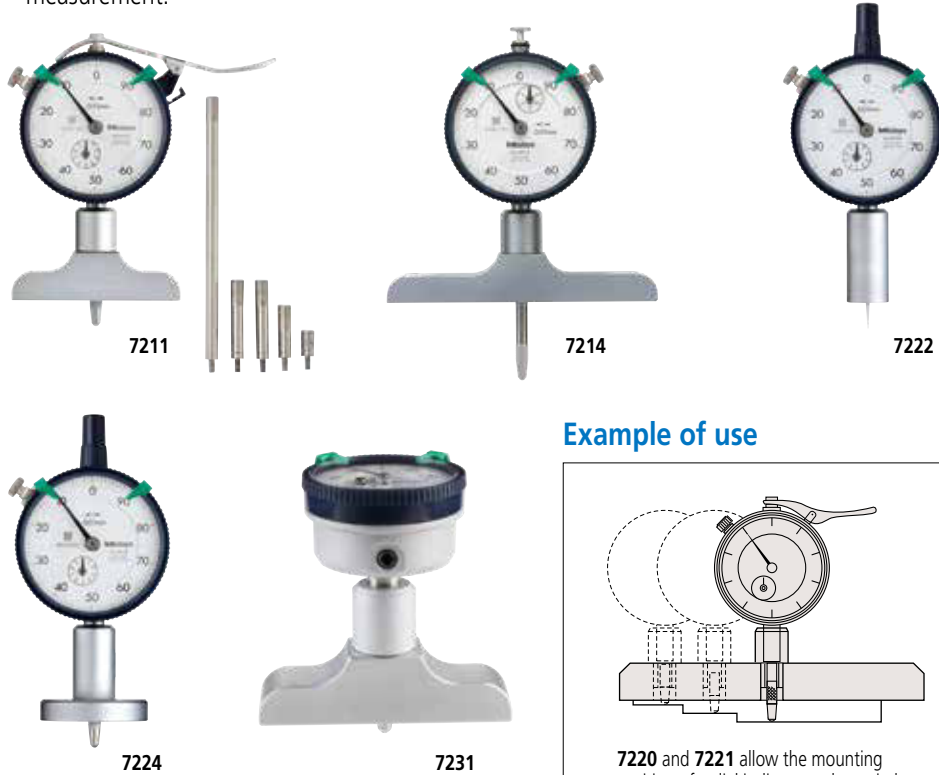

Example of use

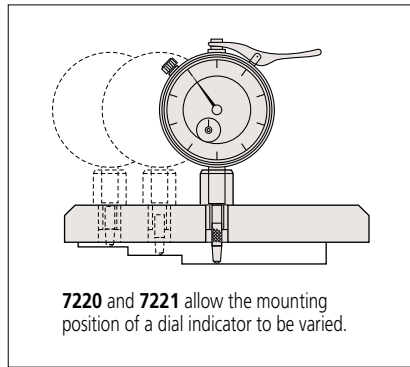

7220 and 7221 allow the mounting position of a dial indicator to be varied.

Note 1

Caution should be exercised when exchanging a contact point of a Depth Gage (Dial/Digimatic Indicator):

- If a different size contact point is mounted, displacement of the contact point from the base contact surface will be changed and as a result, measurement range may not be maintained.
- A contact point cannot be mounted to a Depth Gage if its diameter is too large for the hole diameter of the base.
- Parallelism adjustment with the bottom face of the base is required when mounting a flat contact point such as the flat/needle or carbide-tipped contact point.

Note 2

Caution should be exercised when using an extension rod:

- If the total length of the extension rod exceeds 110 mm (4.5 in) use the instrument in a vertical position (contact point downward).
- Use a master gage (such as gauge blocks) to perform zero-setting when the extension rod is mounted. (Master gage is an optional accessory.)

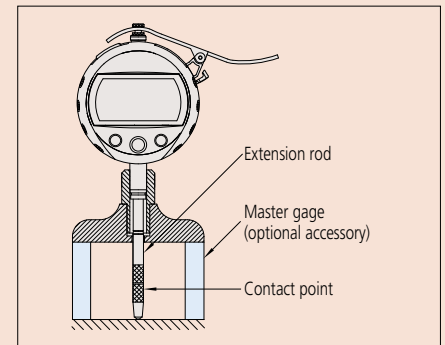

Note 3

Caution should be exercised when indicators are used on a Depth Gage:

- When the indicator is exchanged and a longer extension rod is connected, the contact-point may deflect significantly with an adverse effect on measuring accuracy.
- Order No.543-400B/543-402B for Depth Gage has a measuring force less than 1.5 N.

SPECIFICATIONS

Metric

Order No.	Range (mm)	Graduation (mm)	Accuracy (μm)	Stroke (mm)	Measuring force (N)	Base				Contact point ^{Note 1}	Extension rod ^{Note 2}	Indicator ^{Note 3} (dial indicator)
						W (mm)	T (mm)	Flatness (μm)	Mounting position of a dial indicator			
7210	0 - 10	0.01	±15	10	1.4	40	16	5	1	Provided with a needle point (137413)	5 pcs. (10, 20, 30, 30, 100 mm)	2902SB for Depth Gage
7211	63.5					Provided with a carbide-tipped ball point (21JAA224)						
7212	101.6					Provided with a carbide-tipped ball point (21JAA225)						
7213	63.5					3 pcs. (30, 60, 90 mm)				2952SB for Depth Gage		
7214	101.6											
7220	0 - 200		±30	30	2.5	100	18	5	2	Provided with a carbide-tipped ball point (21JAA224)	5 pcs. (10, 20, 30, 30, 100 mm)	2902SB for Depth Gage
7221	150					3						
7222	∅16											
7223	∅25											
7224	∅40											
7231	0 - 200	±15	10	1.4	5	63.5	16	1	Provided with a carbide-tipped ball point (21JAA224: 17 mm)	5 pcs. (10, 20, 30, 30, 100 mm) Interchangeable contact point (21JAA226: 22 mm)	1162T for Depth Gage (Back plunger type)	

Inch

Order No.	Range (in)	Graduation (in)	Accuracy (in)	Stroke (in)	Measuring force (N)	Base				Contact point ^{Note 1}	Extension rod ^{Note 2}	Indicator ^{Note 3} (dial indicator)
						W (in)	T (in)	Flatness (in)	Mounting position of a dial indicator			
7217S	0 - 8	0.001	±0.002	1	2.5	2.5	0.63	0.0002	1	Carbide ball point (21JZA242)	3 pcs. (1 in, 2 in, 4 in)	2904SB for Depth Gage
7218S						4						
7237T				2.5	4 pcs. (0.5 in, 1 in, 2 in, 4 in) Interchangeable contact point (21JZA243: 0.9 in)	1168T for Depth Gage (Back plunger type)						
7238T				4								

DIMENSIONS

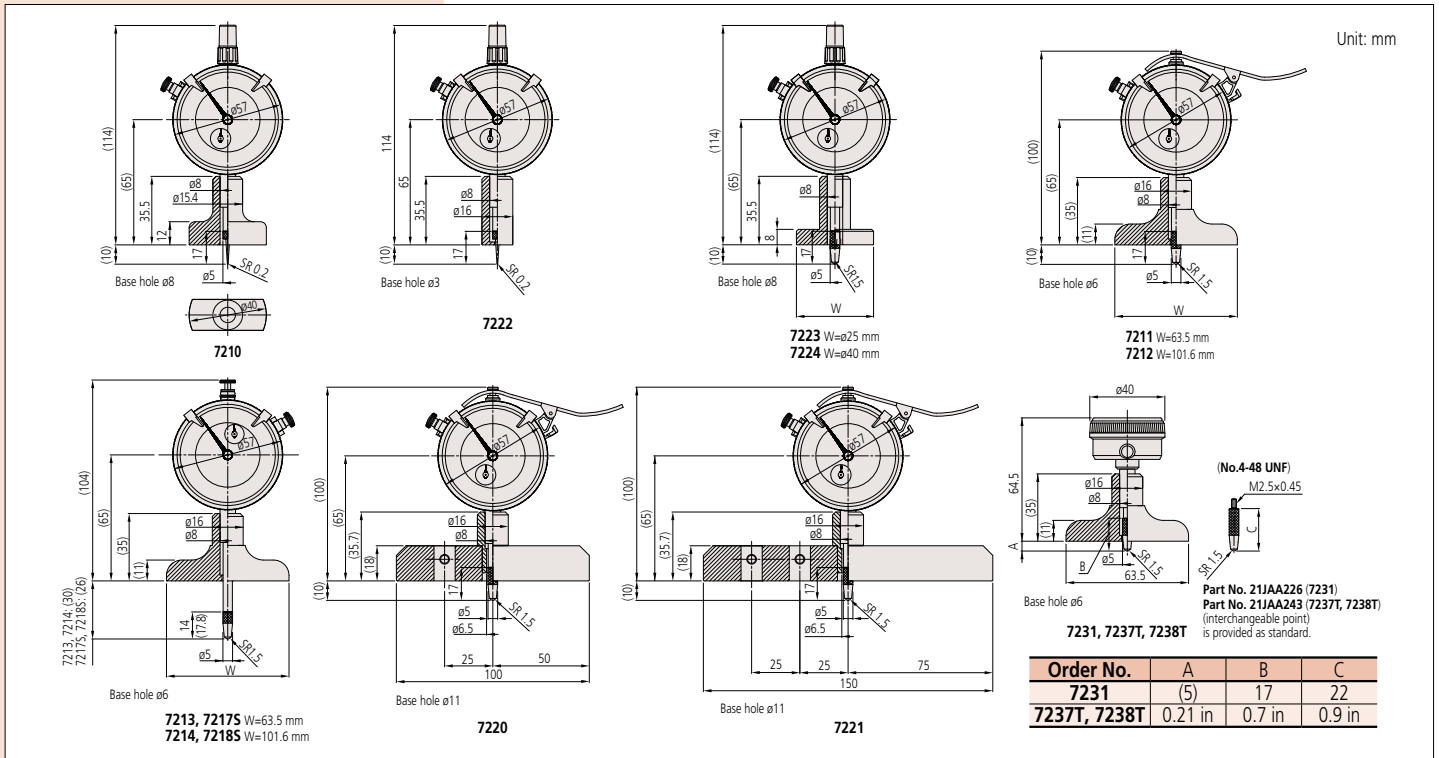

MeasurLink[®] ENABLED
Data Management Software by Mitutoyo

Products equipped with the measurement data output function can be connected to the measurement data network system MeasurLink (refer to page A-5 for details).

ABSOLUTE Digimatic Depth Gage SERIES 547

MeasurLink[®] ENABLED
Data Management Software by Mitutoyo

- Easy-to-read dial effectively prevents misreading.

- Allows integration into statistical process control and measurement systems for models with measurement data output connector. Refer to page A-3.

ABSOLUTE™



547-211

DIMENSIONS

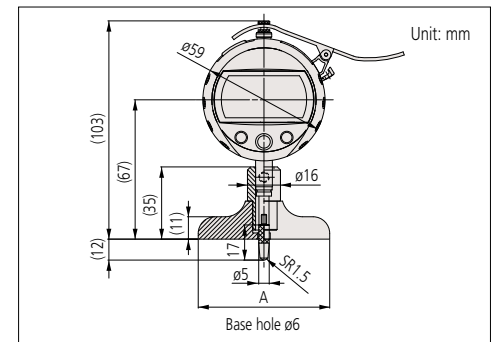

SPECIFICATIONS

Metric

Order No.	Range (mm)	Resolution (mm)	Stroke (mm)	Accuracy ^{Note 4} (μm)	Measuring force (N)	Base			Contact point ^{Note 1}	Extension rod ^{Note 2}	Indicator ^{Note 3}
						W (mm)	T (mm)	flatness (μm)			
547-211	0 - 200	0.01	12.7	±20	1.5	63.5	16	5	Provided with a carbide-tipped ball point (21JAA224)	5 pcs. (10, 20, 30, 30, 100 mm)	543-400B
547-212						101.6					
547-251		0.001		63.5							
547-252				101.6							

Inch / Metric

Order No.	Range (in)	Resolution	Stroke (in)	Accuracy ^{Note 4} (in)	Measuring force (N)	Base			Contact point ^{Note 1}	Extension rod ^{Note 2}	Indicator ^{Note 3}
						W (in)	T (in)	flatness (in)			
547-217S	0 - 8	0.0005 in/0.01 mm	0.5	±0.001	1.5	2.5	0.63	0.0002	Provided with a carbide-tipped ball point (21JZA242)	4 pcs. (0.5 in, 1 in, 2 in, 4 in)	543-402B
547-218S						4					
547-257S		0.00005 in/0.001 mm		2.5							
547-258S				4		0.00008					

Note 1 to 3: Refer to corresponding notes on page D-67.

Note 4: Excluding quantizing error of ±1 count