

CLN

Tilt only (T type)



Daylight color

Pan & Tilt (PT type)



Daylight color

The CLN Series was designed especially for the machine tool industry where oil, oil mist, other cutting fluids and debris is constantly present (rated IP66G and IP67G). Its ability to pan and tilt allows operators to point the light where it's needed most. The aluminum body and tempered glass protect the unit from hot flying debris. The 6500K color temperature (daylight white) allow objects to be seen clearly.

Flexible Angle Adjustment

■ Tilt only (T type)



Can tilt 180o and can be folded to 33mm for easier installation.

■ Pan & Tilt (PT type)

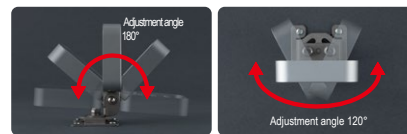

Can tilt 180o or rotated 120o to fit any application. Can be folded to 43mm for easier installation.



Specifications

Model	Light source color	Rated Voltage	Operating Voltage Range	Rated Current Consumption	Total luminous flux (typ.)	Central illuminance (lx/1.0m)	Body materials	Operating Temperature Range	Mounting location/ mounting direction	Protection Rating	Vibration Resistance	Mass
CLN-24-CD-T	Daylight color	24V DC	Rated Voltage ±10%	174mA ±10%/4.2W	550lm	820	Body: aluminum alloy/ Light-emitting component: tempered glass	-40°C - +60°C (90%RH or less, no condensation)	Indoor/ omnidirectional	IP66G/IP67G (JIS C0920) IP69K (DIN 40050 part 9) (Excludes cable tip component)	30Hz total amplitude 0.3mm-p 2 hours each up-down, left-right, forward-back Total amplitude 0.3mm-p (10-57Hz), Acceleration 19.6ms ² (57-150Hz) (JIS C60068-2-6)	0.36kg
CLN-24-CD-PT	Daylight color				550lm	820						0.43kg

Dimensions (mm)

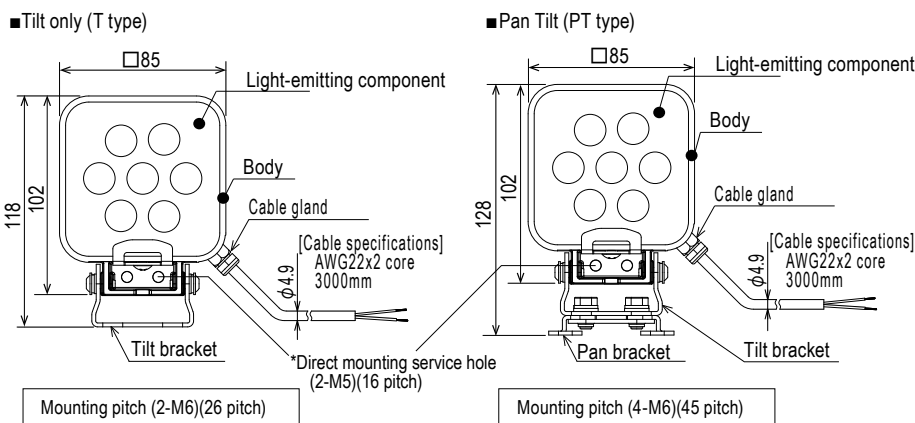

Model Code

CLN-24-CD-PT

Movable Type

T	Tilt
PT	Pan/Tilt

Oil-Proof Test

Passed Oil-proof Test

Product was immersed in the oils listed below in 1:20 dilution at 55oC for 240 hours (10 days).

Company Name	Oil Name
Hangsterfer's	Hangsterfer S500
Yushiro Chemical Industry Co., Ltd.	Yushiroken Synthetic #663
Castrol	Syntilo 9954
Blaser Swisslube	Blasocut BC35LFSW

At the conclusion of each test the product was examined and it was confirmed that there was no swelling, contraction, dissolution, exfoliation, separation, cracks, discoloration, and penetration.

It is recommended that careful investigation be made before purchase since additive agents in oil may differ from those tested and may influence the physical properties of the product.

*Company names, product names, trademarks, etc. of those listed in the table are each company's registered trademarks in Japan or other countries.